



A Rocky Rainbow

PreK

Duration

Pre-Visit: 15 minutes
Visit: 30 minutes
Post-Visit: 20 minutes

Location

Classroom and Gem & Mineral Hall

Supplies

- Worksheet
- Camera
- Paper
- Colored Pencils

Standards

NA

Vocabulary

Red
Orange
Yellow
Green
Blue
Purple
Gem
Mineral
Rock

Concepts

- Rocks and Minerals come in many different colors.

Objectives

- Students will learn that rocks come in many different colors.
- Students will record observations using drawing and photography
- Students will practice presentations skills

Outline

1. In one Pre-Visit session introduce or review colors and identify representative objects of those colors. Also introduce *I Spy* and practice playing.
2. At the Museum review how to play *I Spy* and then break into groups to find and photograph specimens that represent each color in the rainbow.
3. In one Post-Visit session draw the specimens based on the photographs and share drawings with the class.

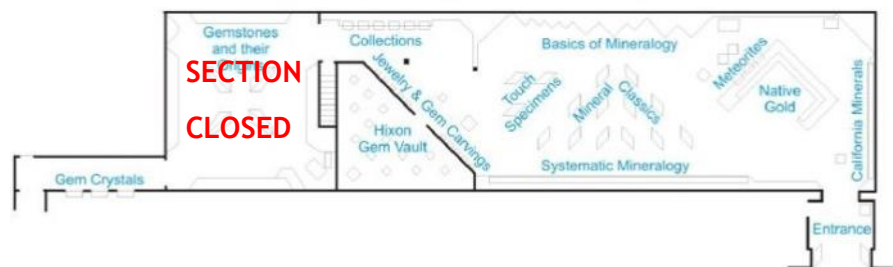

Pre-Visit

Review the colors of the rainbow and have students come up with different things that represent the different colors of the rainbow. Example: fire trucks are red, bananas are yellow, the sky is blue, etc. In the classroom or outside, take students to play a game of I Spy to find things that are on the color spectrum.

Museum Visit

Remind students of the game of *I Spy* they played at school and tell them that that is the game that they will be playing in the Gem and Mineral Hall.

Break students up into groups, making sure that each chaperone has a camera to document what the student groups find.

The teacher/chaperone will have a paper to record the gem and/or mineral the children find that is the color in the rainbow. Chaperones may need to remind the students of the different colors they are looking for.

Post- Visit

Use pictures from the Museum visit and group them into color categories, or use them to draw a picture of the gems or minerals they found that corresponds to the color of the rainbow and share them with the class.

I Spy with my little eye...

Help your students find a specimen in the Gem & Mineral Hall for each color in the table below. Write down its name and take a picture of it to use in the classroom!

Red	Name of specimen: Photo #
Orange	Name of specimen: Photo #
Yellow	Name of specimen: Photo #
Green	Name of specimen: Photo #
Blue	Name of specimen: Photo #
Violet	Name of specimen: Photo #